



22" Open Frame Touchmonitor

TM-2258

Features

- Open Frame
- Slim profile with unique narrow border
- Multiple mounting options
- Open-frame VESA mounting option and removable wing bracket for VESA
- Detachable cables for easy cable harnessing
- Single power supply for all optional devices
- Multilingual and detachable On Screen Display (OSD)
- Comb Serial and USB touch interface
- Super-sensitive, drift-free, precise touch with no overlay
- Long-lasting product cycle
- Worldwide agency approvals



22" Open Frame Touchmonitor

TM-2258



Leadingtouch Open Frame LCD's touchmonitors are designed for easy integration into kiosk, gaming machine, industrial enclosure and other installations where compact, touch-integrated display are preferred. TM-2258 integrate the Leadingtouch's IP65 level Infrared touchscreen, TM-2258 series is Dustproof and Waterproof touchmonitors.

TM-2258 are designed for space saving and easy mounting integrations. The Open Frame configuration along with optional size mounting brackets would enable you to easily customize into kiosks, cabinets, in-wall as well as other enclosures.

TM-2258 will have Leadingtouch Combo interface with dual touch ports for convenience and flexibility. It will enable you to use both the Serial RS-232 as well as USB port for your touch application.

Specifications

Model	TM-2258
Description	22" TFT Open Frame Touchmonitor
Case/Bezel Color	Black
Display	16:10 Ratio 22"Active matrix TFT LCD
Optimal(native) resolution	1680 x 1050 @ 60Hz
Synchronization Range	72.1 KHz horizontal, 60 Hz Vertical
Useful screen area	Horizontal: 18.8"(477.7mm);Vertical: 11.81" (300.1mm)
Colors	16.7 million
Brightness	LCD panel: 300 cd/m ² (typical) With Infrared touchscreen: 280 cd/m ² (typical)
Pixel Pitch	0.511 x 0.511 mm
Response Time	5 msec (typical)
Contrast ratio	1000:1 typical
Viewing angle(typical, from center)	Horizontal (left/right): 170°(85° /85°) Vertical (up/down): 160°(80° /80°)
Backlight Lamp life	50,000 Hrs to 1/2 brightness
Input video format	VGA or DVI optional
Input video signal connector	VESA DDC 1/28
On Screen Display(OSD)	Remote OSD with 1.2m cable
Touch Technology	Infrared
Touch Interface	Combo serial (RS232) and USB interface
Touch Resistive Time	15ms
Mounting Options	Rear Fixed, 75 mm & 100mm VESA mount
Power supply	Type: External AC to DC power brick Monitor input: +12VDC ±5%, 3.2 A typical, 3.8 A max. AC to DC power brick input: 100-240 VAC, 50/60 Hz
Power Consumption	31W Typical
Temperature Range	Operating: 0°C to 50°C; Storage: -20°C to 60°C
Humidity Range	Operating: 10%-90%; Storage: 5%-90%, Non condensing
Touchmonitor Dimension	556x 378 x 78(mm)
Warranty	Monitor: 3 years'; LCD Panel: 1 year
Agency Approvals	FCC, CE, RoHS compliant



22" Open Frame Touchmonitor

TM-2258

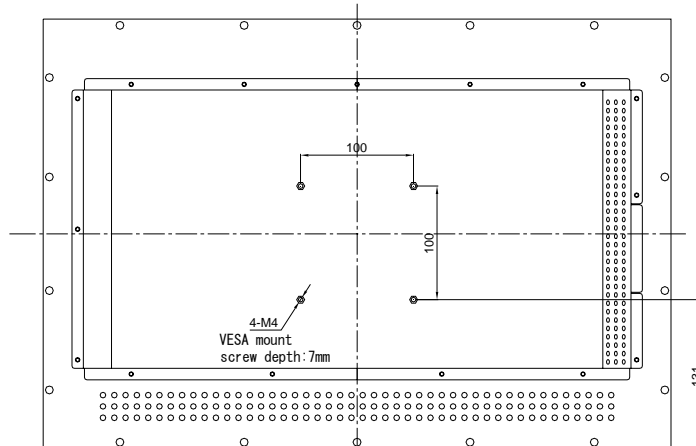
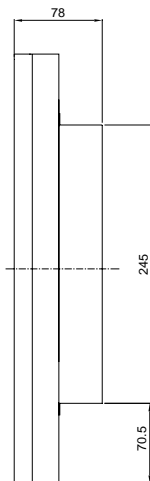
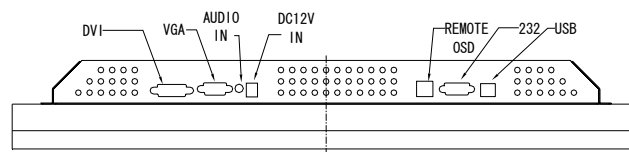
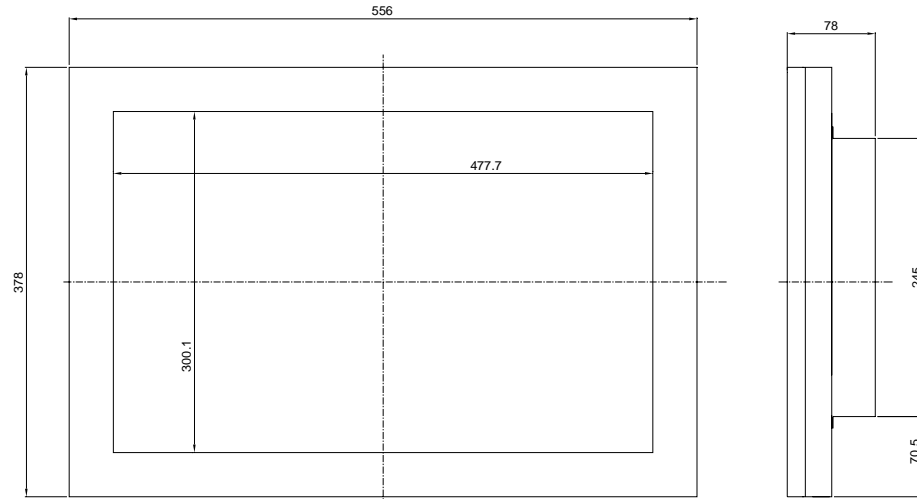

22" Open Frame Touchmonitor

TM-2258

Optional Accessory: Remote OSD Controller Box

