



17" Rear Mount Touchmonitor

TM-1737

Features

Rear Mount

Slim profile with unique narrow border

Multiple mounting options

Rear-mount VESA mounting option and removable wing bracket for VESA

Detachable cables for easy cable harnessing

Single power supply for all optional devices

Multilingual and detachable On Screen Display (OSD)

Comb Serial and USB touch interface

Super-sensitive, drift-free, precise touch with no overlay

Long-lasting product cycle

Worldwide agency approvals

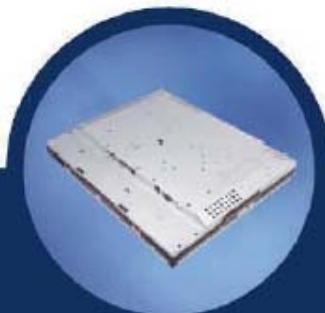

17" Rear Mount Touchmonitor

TM-1737



Leadingtouch Rear Mount LCD's touchmonitors are designed for easy integration into kiosk, gaming machine, industrial enclosure and other installations where compact, touch-integrated display are preferred. TM-173 series integrate the Leadingtouch's IP65 level SAW, Resistive or Capacitive touchscreen, TM-173 series is Dustproof and Waterproof touchmonitors.

TM-173 series are designed for space saving and easy mounting integrations. The rear-mount configuration along with optional side mounting brackets would enable you to easily customize into kiosks, cabinets, in-wall as well as other enclosures.

TM-173 series will have Leadingtouch Combo controller with dual touch ports for convenience and flexibility. It will enable you to use both the Serial RS-232 as well as USB port for your touchscreen application.

Product Information

P/N	Touch Technology
TM-1739	SAW touchscreen
TM-1734	4 Wire Resistive touchscreen
TM-1735	5 Wire Resistive touchscreen

Specifications

Model	TM-1737
Description	17" TFT Rear Mount Touchmonitor
Case/Bezel Color	Black
Display	4:3 Ratio Active matrix TFT LCD
Optimal(native) resolution	1280X1024@60Hz
Synchronization Range	Horizontal:30-80 kHz; Vertical: 60-75Hz
Useful screen area	Horizontal: 13.3" (338 mm);Vertical: 10.6" (270.3 mm)
Colors	16.7 million
Brightness	LCD panel: 300cd/m2 (typical) With touchscreen: 280 cd/m2 (typical)
Pixel Pitch	0.264 x 0.264 mm
Response Time	8 msec (typical)
Contrast ratio	500:1 typical
Viewing angle(typical, from center)	Horizontal (left/right): 140°(70° /70°) Vertical (up/down): 130°(70° /60°)
Backlight Lamp life	50,000 Hrs to 1/2 brightness
Input video format	VGA or DVI optional
Input video signal connector	Mini D-Sub 15-Pin VGA type
On Screen Display(OSD)	5W Remote OSD with 1.2m cable
Touch Technology	Capacitive(Resistive, SAW Optional)
Touch Interface	Combo 10ms232 and USB interface
Touch Resistive Time	10ms
Mounting Options	Rear Fixed, 75 mm & 100mm VESA mount
Power supply	External:100-240V AC, 50-60 Hz
Power Consumption	50W max
Temperature Range	Operating: 0°C to 50°C; Storage: -20°C to 60°C
Humidity Range	Operating: 10%-90%; Storage: 5%-90% no condensing
Touchmonitor Dimension	368x 306 x 48(mm)
Shipping Carton Dimension	460x 409 x 175(mm)
Weight(approx.)	Monitor: 3.8kg / shipping: 6kg
Warranty	Monitor: 3 years'; LCD Panel: 1 year
Agency Approvals	FCC, CE, RoHS compliant

17" Rear Mount Touchmonitor

TM-1737

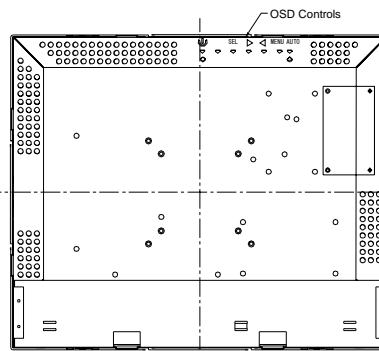
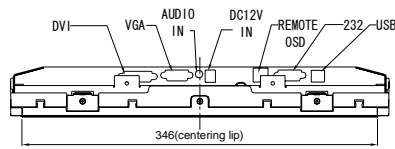
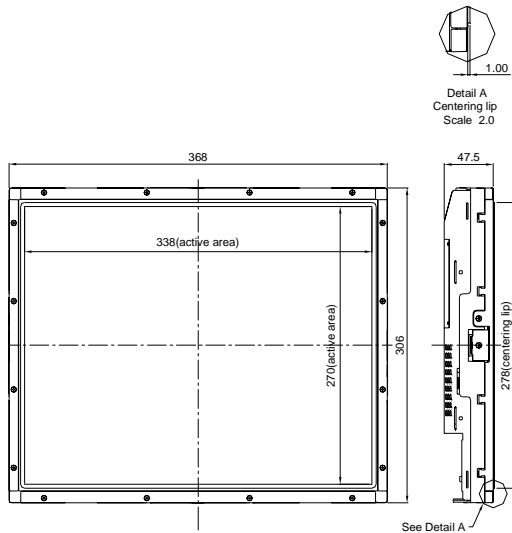

RECOMMEND CUSTOMER PANEL CUT-OUT

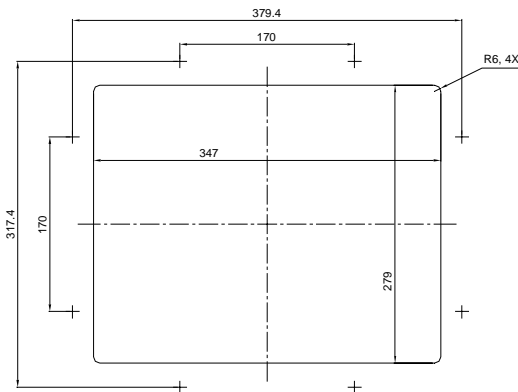

SIDE MOUNT VERTICAL

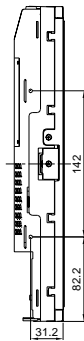

VESA MOUNT

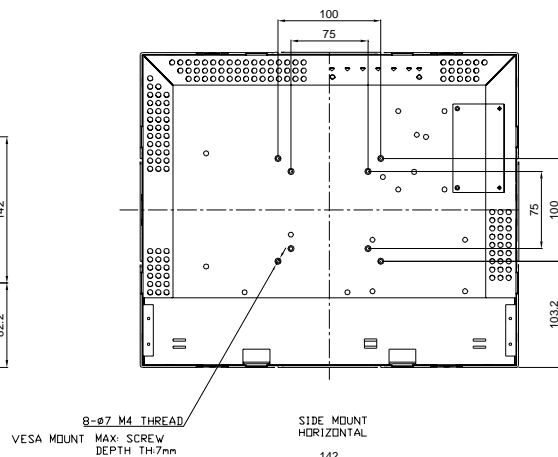

SIDE MOUNT HORIZONTAL

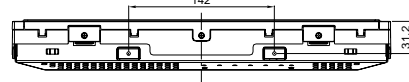

MOUNTING BRACKET ADJUSTMENT RANGE

REAR MOUNT WITH BRACKETS HORIZONTAL OR VERTICAL

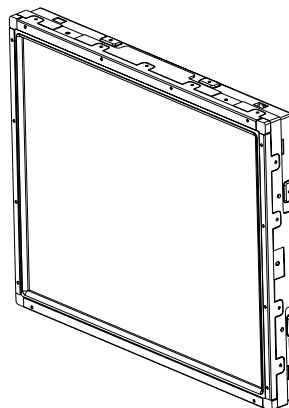
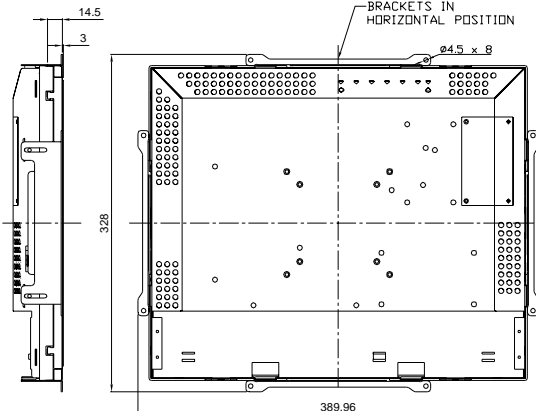

17" Rear Mount Touchmonitor

TM-1737

Optional Accessory: Remote OSD Controller Box

